



TIP SHEET

Installation Tips - (Crimestopper RS00) & (Fortin EVO-ALL) For:

T3612-1a

Acura	TL	2004-2006		Honda	Accord (Gas)	2003-2007
Acura	TSX	2004-2008		Honda	Accord (Hybrid)	2005-2007
				Honda	Ridgeline	2006-2013

Thank you for purchasing your remote start from MyPushcart.com - an industry leader in providing remote starts to do-it-yourself installers since 1999. We've put this tip sheet together to help you with your installation.

The RS00 add-on remote starter from Crimestopper is the controller for the system, and uses the vehicles lock pulses generated by your OEM factory remotes to start the vehicle. Quickly pressing the lock button on your OEM factory remote three times in succession will start the vehicle.

The EVO-ALL interface module will temporarily override your antitheft system when you remote start. It also eliminates the need for a lot of the wiring typically required for remote start installation. It communicates with both the remote starter as well as the vehicle's computer through data.

Overview:

This installation requires that you connect to a total of 9 wires in the vehicle, plus one connection to ground. All the connections are detailed and illustrated in the following pages.

When you open up your remote start, you're going to see a whole bunch of wires. You're not going to use all of them. The remote starts are designed with wiring options for a variety of cars and no car is going to use all of them. Here's where this tip sheet comes into play. The wiring chart and diagram will help you locate the wires that you're going to need to connect for this installation. We are also going to address programming, testing, and operation.

Step 1- Wiring

Step 2- Programming

Step 3- Testing

Step 4- Button it up!

Step 1 – Wiring

Any wires that are NOT listed in the table/diagram are NOT USED. Also, in most cases, the wires in the kit are way longer than needed and excessive length can be shortened. Do not cut the wires you are connecting too short, this will allow you some flexibility when it comes time to stow the remote start after the installation is completed. The unused wires in the kit can be trimmed as well, but do not cut the wire all the way to an unusable point - just in case it is needed for any future features or installation. Use electrical tape to insulate all unused wires so they do not make electrical contact with anything else.

To prepare for your installation, remove the plastic shroud that covers the steering column. The shroud is held in place by a combination of screws and clips. Be careful when removing clips – especially in cold weather.

There are two locations in the vehicle where you'll need to make wiring connections.

Location 1: Dash Fuse Box.

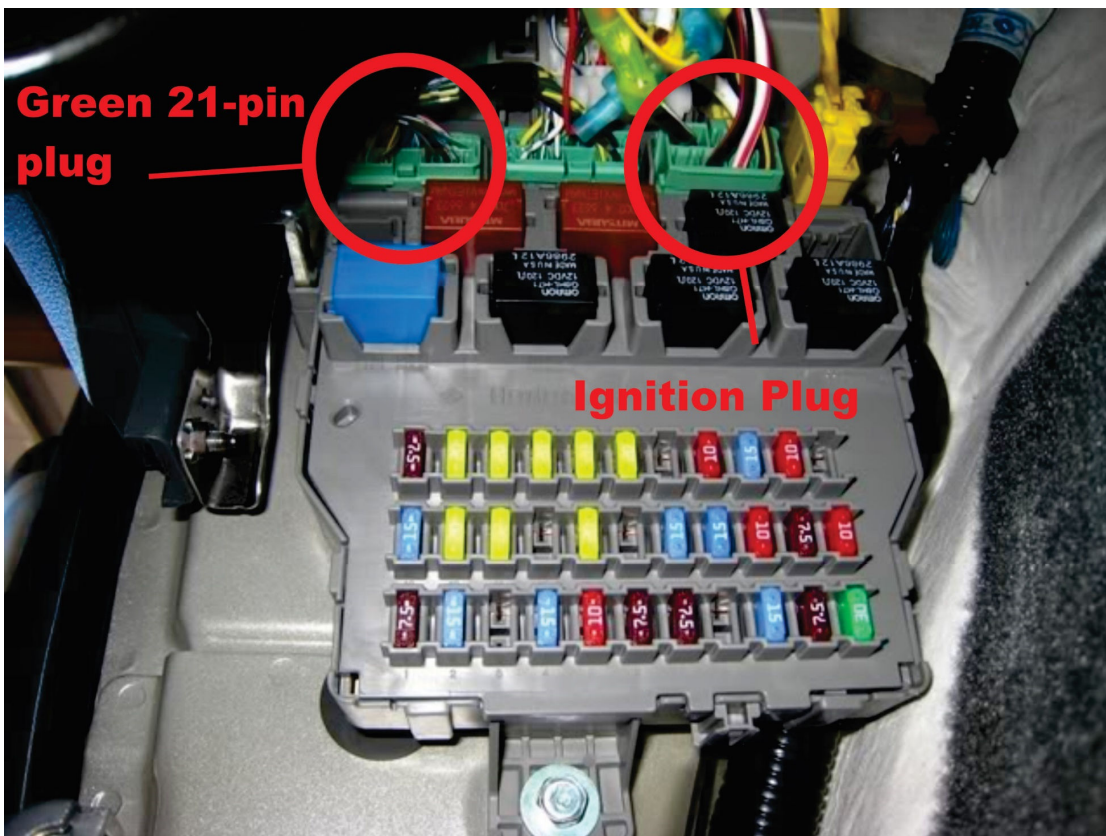

Make these connections at the Dash Fuse Box:

Vehicle	RS00 Wire Color	EVO-ALL Wire Color	Vehicle Wire Color	Function
TL 2004-2006	RED x 2 (6-Pin)		White	Battery
	Pink (6-Pin)		Black/Yellow	Ignition
	Grey (6-Pin)		White/Red	Accessory
	Pink/White (6-pin)		Black/Red	2 nd Accessory
	Brown (6-Pin)		Black/White	Starter
	Green (3-pin, RED plug)		Yellow/Black. 12-pin green plug, pin 12	3x Lock activation wire
		Brown (5-pin)	Brown/Black on Green 21-pin plug	CAN SW
TSX 2004-2008, Accord Gas 2003-2007, Accord Hybrid 2006-2007	RED x 2 (6-Pin)		White	Battery
	Pink (6-Pin)		Black/Yellow	Ignition
	Grey (6-Pin)		White/Red	Accessory
	Pink/White (6-pin)		Black/Red	2 nd Accessory
	Brown (6-Pin)		Black/White	Starter
	Green (3-pin, RED plug)		Yellow/Black. 12-pin green plug, pin 12	3x Lock activation wire
		Brown (5-pin)	Brown/Red on Green 21-pin plug	CAN SW
Accord Hybrid 2005	RED x 2 (6-Pin)		White	Battery
	Pink (6-Pin)		Black/Yellow	Ignition
	Grey (6-Pin)		White/Red	Accessory
	Pink/White (6-pin)		Black/Red	2 nd Accessory
	Brown (6-Pin)		Black/White	Starter
	Green (3-pin, RED plug)		Yellow/Black. 12-pin green plug, pin 12	3x Lock activation wire
		Brown (5-pin)	Light Green on Green 21-pin plug	CAN SW
Ridgeline 2006-2013	RED x 2 (6-Pin)		White	Battery
	Pink (6-Pin)		Black/Yellow	Ignition
	Grey (6-Pin)		Yellow	Accessory
	Pink/White (6-pin)		White/Black	2 nd Accessory
	Brown (6-Pin)		Black/White	Starter
	Green (3-pin, RED plug)		Yellow/Black. 12-pin green plug, pin 12	3x Lock activation wire
		Brown (5-pin)	Brown/Black on Green 21-pin plug	CAN SW

Location 2: Transponder Plug



Make these connections at the Transponder Plug. Note that the Security Light wire (Pin 5) must be cut – resulting in a “vehicle side” and a “plug side”.

Vehicle	EVO-ALL Wire Color	Vehicle Wire Color	Function
TL 2004-2006, TSX 2004-2005, Accord 2003-2007, Ridgeline 2006-2013	Light Blue (20-pin)	Red/Blue, Pin 2	Data
	White/Red (6-pin)	Blue/Orange Pin 5 – vehicle side	Security Light
	White/Green (6-pin)	Blue/Orange Pin 5 – plug side	Security Light
TSX 2006-2008	Light Blue (20-pin)	Red/Blue, Pin 2	Data
	White/Red (6-pin)	Blue/Orange Pin 5 – vehicle side	Security Light
	White/Green (6-pin)	Blue/Orange Pin 5 – plug side	Security Light
Accord Hybrid 2005-2007	Light Blue (20-pin)	Yellow, Pin 2	Data
	White/Red (6-pin)	Red Pin 5 – vehicle side	Security Light
	White/Green (6-pin)	Red Pin 5 – plug side	Security Light

In addition to the connections into the vehicle, three connections are required between the RS00 and the EVO-ALL:

1. Connect the Dark Blue of the EVOALL 20-pin harness to the Yellow/Black from the RS00 12-pin harness
2. Tap the Yellow from the EVOALL 20-pin harness on to the Pink from the RS00 6-pin harness
3. Use the 4-pin Datalink cable (red, black, blue & white wires) to connect the EVOALL to the RS00.

Connect the Black wire in the RS00 12-pin harness to ground

Optional Connections:

Parking Lights –

1. Tap the Black/Red from the RS00 12-pin harness on to one of the large Red wires in the remote start 6-pin harness
2. Connect the White wire in the RS00 12-pin harness to the vehicle parking light wire – Red/Black in the Dash Fuse Box, white 45-pin connector, Pin 31.

Step 2 – Programming: EVOALL Module

The EVO-ALL will monitor your vehicle brake pedal and send the data to the remote starter, saving you from making the wired connection. Because the add-on remote starter needs to have programming options changed, and can only have the values of each option changed using the brake pedal, you will need to program the EVO-ALL module before you program the remote starter. Perform the following steps using your vehicles' key, and the programming button that is built onto the side of the EVO-ALL:

PROGRAM.: 1

ACURA / HONDA

1

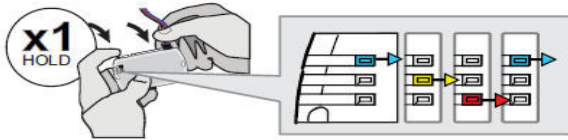

Press and hold the programming button:
Insert the 4-Pin (Data-Link) connector.

↳ The LED will alternate between BLUE, YELLOW and RED flashes.

2

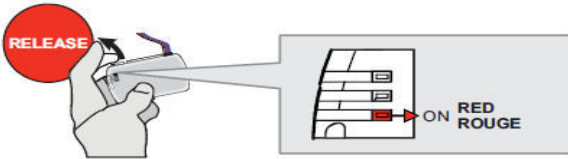

Release the programming button when the LED is RED.

If the LED is not solid RED disconnect the 4 Pin connector (Data-Link) and go back to step 1.



3

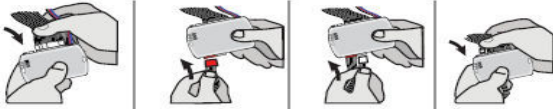

Insert the required remaining connectors.

4

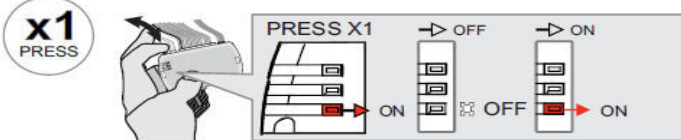

Press and release the programming button once (1x).

↳ The RED LED will turn OFF and then back ON.

5

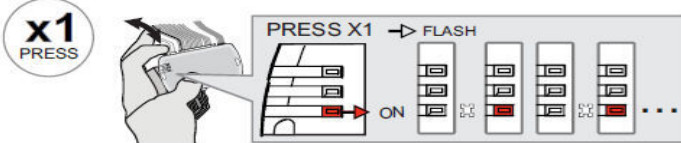

Press and release the programming button once (1x).

↳ The RED LED will flash 1 once each second.

6

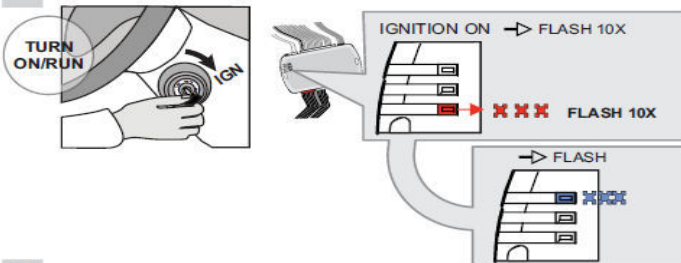

Turn the Ignition to the ON/RUN position.

↳ The RED LED will flash rapidly 10x times.
Key bypass programmed.

↳ The BLUE LED will flash rapidly.
CAN-Bus programmed.

7

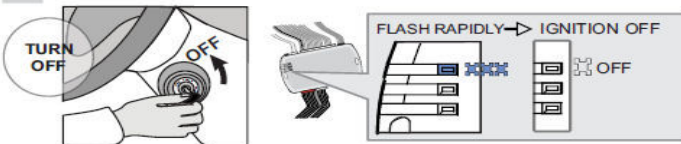

Turn the Ignition to the OFF position.

↳ The BLUE LED will turn off.



The module is now programmed.

Use the remote of the remote starter or security system to test all of the supported features to ensure proper programming.

Programming: RS00 remote starter:

Once you have successfully programmed the EVO-ALL, you will need to change the RS00 remote starters programming option 17 from its default “1 Pulse” setting to the “3 Pulse Start” value. This will initiate the remote start sequence from 3 lock presses on your OEM remote instead of 1. Complete the following steps using your vehicles key, your vehicles brake pedal, and the valet programming button that plugs into the RS00.

1. Using your key, turn the vehicle Ignition “ON” . (Do not start the vehicle)
 2. Within 5 seconds of step 1, press the valet switch 5 times to access option programming.
 - *You will hear 5 clicks from the RS00 brain, and if connected, the parking lights will flash and horn will honk. Wait for the unit to finish clicking/flashing/honking.*
 3. Within 10 seconds of step 2, press the valet switch another 17 times to access option 17.
 - *You will observe a click/flash/honk each time you press the button, carefully count the clicks/flashes/honks until you reach option 17.*
 4. Firmly press the brake pedal 1 time to change option number 17 to the “3 Pulse” value.
 - *You will then observe 1 click/flash/honk to confirm the change.*
 5. To exit programming, turn the ignition key to the “OFF” position. Or, you can wait 10 seconds for programming mode to expire.
 - *Programming is complete.*
- If you wish to change more features, the programmable features chart along with instructions can be found beginning on page 14 of the installation instructions book that comes in the box with your RS00.

– Tips for Connecting the Activation Wire

In some vehicles, the EVO-ALL will pick the lock motor signal up from the vehicle. If after programming the EVO-ALL, the blue LED flashes when you press ‘lock’ on your remote, then you will not need to make this connection.

The GREEN activation wire (RS00 3-Pin harness with RED plug) takes a ground signal from your door lock motors and uses that as a trigger to engage the remote start. That’s how pressing ‘lock’ on your OEM remote 3 times starts the car.

Testing the correct wire will show (-) ground when at rest, then when the lock button is pressed the wire will momentarily show (+) positive as the door lock is energizing, then return back to (-) ground where it will rest. It is the return back to ground pulse on the vehicle lock motor wire that the remote starter is looking for. In most installations, the activation wire can be connected directly to the vehicle “Motor Lock” wire and everything will function correctly. Some customers have reported an issue on that wire that causes the car to start on the first ‘Lock’ press, even after installer programming option #1 has been changed to ‘3 presses’ for activation. If you experience this problem, adding a relay to the activation wire will resolve this issue. Most vehicles will not need the relay, but there’s no harm in using it even if yours does not. You can choose to install the relay with the rest of the system, or you can install it only if it turns out you need it – it’s up to you. If you install the relay on the activation input, connect it as shown below.

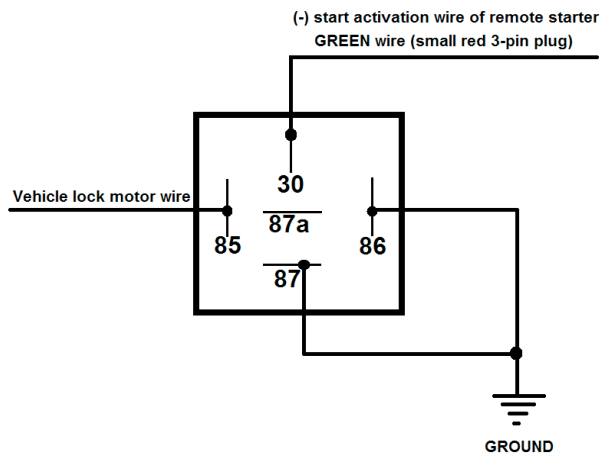

RELAY HARNESS COLOR CHART:

30 = Blue
85 = White
86 = Black
87 = Yellow
87a = Red

- After connecting the activation wire. Test the system again, by pressing the 'Lock' button on your fob 3 times.

Step 3 - Test the System

Once all programming is done, you should test the system to make sure everything is working properly before you connect the activation wire and close up the installation.

1. Press the lock button 3 times in a row on your OEM remote.
 - The parking lights & gauges should power up and in a moment, the vehicle should start.
2. Make sure the vehicle stays running, and that the climate controls are working.
3. Press the brake pedal.
 - The engine should shut down.
4. If your test is successful proceed to "step 4 - Connect the Activation Wire and close it up" below.
 - If your test was unsuccessful, go back and re-check your wiring and programming.

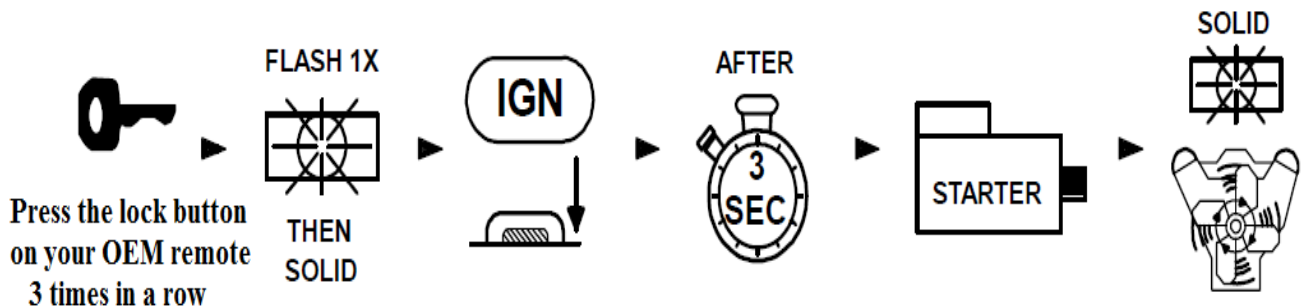

Step 4 - Close it Up!

Now gather up all your wiring and neatly bundle it together using zip ties or electrical tape. Find a secure place to put the remote start module and use zip ties to secure it. **Make sure that the remote start wires are not near any moving parts on the steering wheel, pedals or emergency brake!**

Operation:

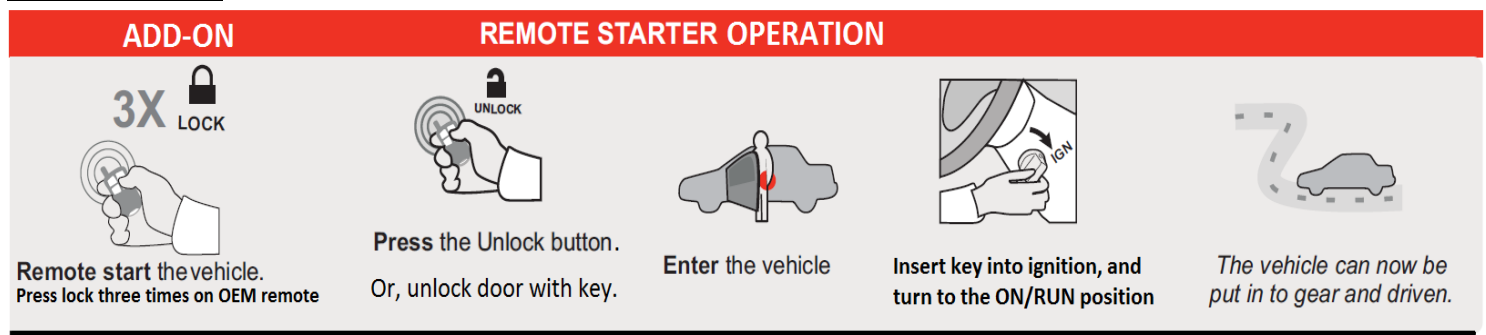

Installer's Tips:

Tip #1 – Where Everything Goes

1. *Remote start module* – the wiring for the module is done under the dash on the driver's side, so you'll want to install the module in that general area. Before you start wiring, look for a location where there's some open space that will fit the module. Pay attention to moving parts like the pedals, e-brake and steering column. Be sure to route your wiring away from those areas.
2. *Bypass module* – can be stowed along with the remote start.
3. *Programming button* – Requires a ¼" hole. Usually put in the driver's kick panel (that's the area forward of the door), the driver's side of the center console, or the underside of the dash.
4. *Status LED* – Not required for normal operation but can be helpful for troubleshooting. Can be mounted anywhere you like – or unplugged and not used once the installation is completed.
5. *Activation relay* – can be stowed along with the remote start.

Tip #2 – How to make your wiring connections

It's very important that all your wiring connections be solid and secure. All remote start connections are "tap on" connections. This means that you do not need to cut the wires in the car. You simply need to "tap on" to the wires in the car to make your connections. Here are three different ways to do this:

Method 1 – Solder and tape

This is the method preferred by the best professional installers. It makes for the most reliable connections, but it is also the most difficult to do. Sometimes there isn't enough room in the wiring harness to safely solder a wire without damaging adjacent wires, but if you have the soldering skills, go for it. To make a connection, strip back a section of the insulation on the wire in the car. On heavy gauge wires, 1" is about the right amount. On lighter gauge wires, ½" is fine. Strip 1" of insulation off the end of the remote start wire. Tin the bare section of wire in the car. Wrap the remote start wire around the tinned section and then carefully solder it in place. Wrap the splice tightly with electrical tape.

Method 2 – Wrap and tape

This is the most popular method and is also very reliable. Strip back a section of the insulation on the wire in the car. On heavy gauge wires, 1" is about the right amount. On lighter gauge wires, ½" is fine. Strip 1" of insulation off the end of the remote start wire. Separate the strands of the wire like this:



Pass the wire from the remote through the opening as shown below

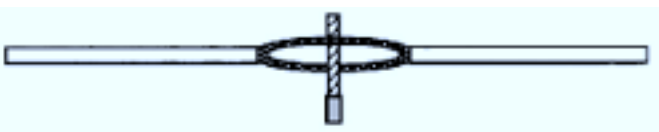

Wrap the remote start wire around both sides of the car wire, then back around itself as shown below



Use electrical tape to wrap the connection and secure the wires together. A wire tie will help prevent the tape from unraveling in the future.

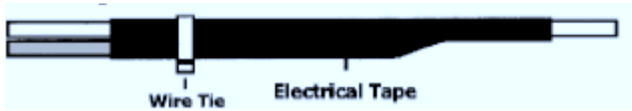

Method #3 – “T-Taps”

T-taps are plastic clips that are squeezed onto the wires in the car. The wire from the remote start goes into the tap and the whole thing is crimped together. T-taps come in different sizes for different size wires. Use yellow t-taps for the larger wires in your main power harness. Red t-taps are good for the smaller wires. Tape and wire tie the connections as shown in the “wrap and tape” section above – that will prevent the t-taps from ever opening up.

Using T-Taps

Use a pair of pliers to attach the quick-connects to the wires in your car. Hold the quick connect as shown below in Figure 1, then clamp it on to the wire as shown in Figure 2. There is a locking tab at the front of the connector (Figure 3) – make sure it is secure and locked in place when you are done.



Figure 1



Figure 2



Figure 3



TIP SHEET

Using Omega CARLINK 3G smartphone vehicle interface with Crimestopper remote starters.

TCLCS

Please Note: Your CarLink Smartphone interface requires activation after the wiring is complete. This must be done during normal business hours (M-F, 9-5). Please plan your installation accordingly. There is no time limit, so if you install the CarLink over the weekend an activate during the week, that's fine.

The Omega CarLink smartphone adaptor is a module that connects to a compatible remote starter, which will interface commands sent from your smartphone to control remote starter functions in your vehicle. The basic controls will give you the ability to start / stop your vehicle engine, lock / unlock the doors, and pop your trunk through data all from your smartphone from anywhere in the world that there is cellular coverage. All commands are configurable to icons displayed on your smartphone. The CarLink also has 2 auxiliary channels that may be wired up to control peripheral functions as well. Some examples of use are: widow roll up/down, sunroof open/close, and heated seats, but the possibilities are endless. Any extra parts required for peripheral controls are not included, please refer to the device manufacturer for support on those products. This document will only be covering basic controls and installation.

Your Omega CarLink will come with general instructions in the box. The purpose of this document is not to replace those instructions, but to help simplify them, and provide information on how to use the device with your Crimestopper remote starter. If you have any questions on the installation of this unit, feel free to call:

MyPushcart Tech Support: (520)572-2220 (Mon-Fri 9AM-5PM Arizona time)

Crimestopper remote start preparation:

The CarLink works at a 9600 Baud rate. Before beginning the physical install of the CarLink, you will need to make the provision on the remote starter that makes the two compatible with each other. This is done through option programming on the Crimestopper remote starter. Look in the programming option table located in the middle of the installation instructions booklet that comes with your Crimestopper unit. Find the option number for "smartphone baud rate", you

will need to change this to value 1 "9600". After the baud rate is set, proceed with the physical installation on the CarLink.

Physical install of CarLink:

The CarLink will have 4 wires with a 4-pin plug at the end, and 4 loose wires with no plug at the end. The loose white wire will need to be connected to ignition power to read when the ignition is on. Use a T-Tap and connect this wire to the Pink Ignition wire of the Crimestopper remote start 6-Pin power harness. The other 3 loose wires are not used.

Use the 4-Pin cable (included) to connect the CarLink to the 4-Pin Phone Port on the side of the Crimestopper remote start.

Once plugged in to the Crimestopper unit, the CarLink will initialize and begin to link up to the network. Monitor the built in LED's on the CarLink to make sure they behave correctly as described in the quick reference guide. It is important to face the CarLink with the label facing up toward the sky, with no metal interference. A good place is right under the plastic of the dash directly below the windshield.

Activation of CarLink:

Once you get the LEDs on the CarLink to flash as they should to indicate uplink is ready, you will need to test the system. For this you can either call Omega or MyPushcart for a 4 digit pass code, which will be needed along with the 20-digit ICC ID (SIM) when activating your account.

- Omega: (800) 554-4053 (Mon-Fri 9AM-5PM Eastern Time)
- Mypushcart: (520)572-2220 (Mon-Fri 9AM-5PM Arizona time)

Visit: www.omegacarlink.com

Download the app to your smartphone.

Enter the required info to set up your account.

For further info on setting up your account, refer to documents included with your CarLink Smartphone interface module

Enjoy your new Omega CarLink and Crimestopper remote starter!